

Kohala Ranch Vacant Land & Homes Available For Purchase

as of 05/06/2024

Vacant parcels in the Heathers Section (lower elevations):

Lot #	Size of parcel	Listed Price	Listing Agents' Comments
247	3.58 acres	\$369,000	existing site work clearly defines building pad
303	3.08 acres	\$390,000	build your dream home here
199	3.47 acres	\$430,000	tucked away from the hustle and bustle
236	3.79 acres	\$500,000	private and secluded building site

Vacant parcels in Heathers II (slightly higher elevations):

821	41,600 square feet	\$499,000	special and rare lower elevation lot
819	35,384 square feet	\$509,000	be enchanted by the unrivaled beauty

Vacant parcels in the Meadows One Section (middle elevations):

458	*	3.07 acres	\$299,000	offers several building site choices
438	*	3.72 acres	\$335,000	don't let the low price fool you
481		3.25 acres	\$399,000	approximately 1,900 feet above sea level
423		3.18 acres	\$415,000	sweeping panoramic views
498	*	3.44 acres	\$425,000	backs up to hundreds of vacant acres
372	*	3.19 acres	\$445,000	adjacent to two 10-acre parcels
542		5.49 acres	\$450,000	offers a commanding viewpoint
398		3.00 acres	\$500,000	parcel offers stunning views

Vacant parcels in the Meadows Two Section (middle elevations):

686		5.07 acres	\$465,000	elevation of approximately 1.900 feet
621	*	5.07 acres	\$499,000	this 5+ acre lot checks all the boxes

Vacant parcels in the Summit Section (higher elevation):

142		10.33 acres	\$545,000	positioned at a slightly cooler elevation
116		10.20 acres	\$550,000	an unparalleled vantage point
132		10.02 acres	\$575,000	feel on top of the world
110		10.26 acres	\$649,900	beautiful mountain, ocean and sunset views

Already-built houses:

Lot #	Location	Lot Size	Size of House	# Bedrooms/Bathrooms	Listed Price
328	Heathers	5.00 acres	3675 square feet	4 / 4,0,0	\$4,240,000
835	Heathers II	1.09 acres	2769 square feet	4 / 3,0,1	\$4,600,000

NOTE: The Number of Bathrooms is shown as "#,#,#" to mean Full (with a tub), ¾ (with shower), ½ (powder room)

For a tour of Kohala Ranch, contact Jim Donovan at (808) 880-9000.

Jim Donovan represents buyers, unless otherwise disclosed.

* Except for lots #372, #438, #458, #498 and #621, properties discussed herein are listings of other real estate agents who represent the sellers.

Hoku Star Realty
James M. Donovan, Principal Broker
JD-CPA@Kona.net

James M. Donovan is licensed in both Hawaii and California as both a Real Estate Broker and as a Certified Public Accountant. License numbers are HI RB-19185, HI CPA-3417, CA RB-0930737 and CA CPA-19485. Both states' real estate licenses are active, both states' CPA licenses are current, and all licenses are in good standing. However, Jim is inactive as to the profession of public accounting.

Hoku Star Realty
HokuStar.com
 (808) 880-9000

James M. Donovan, Principal Broker
 RB-19185

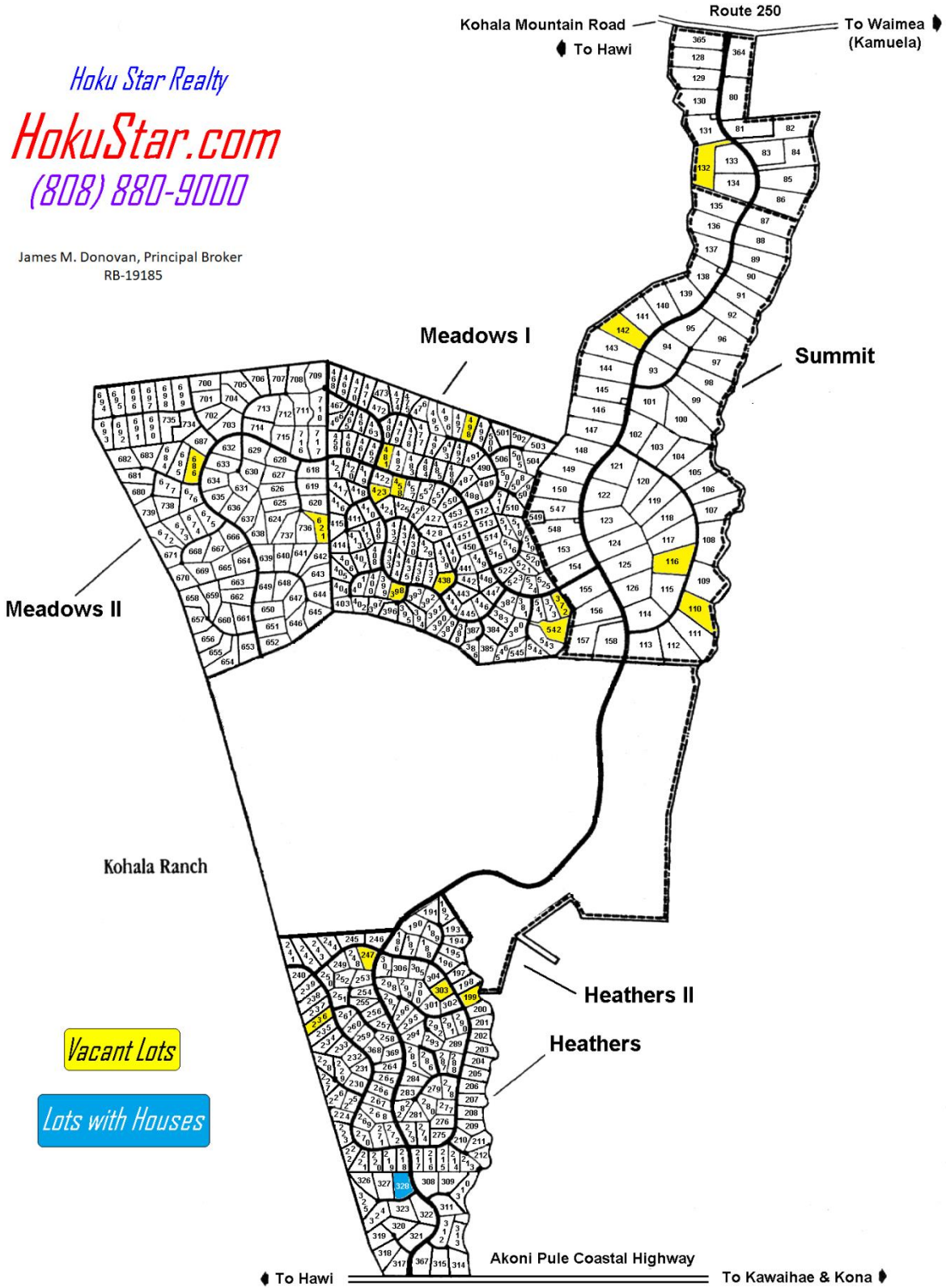

Lots with Houses

Vacant Lots

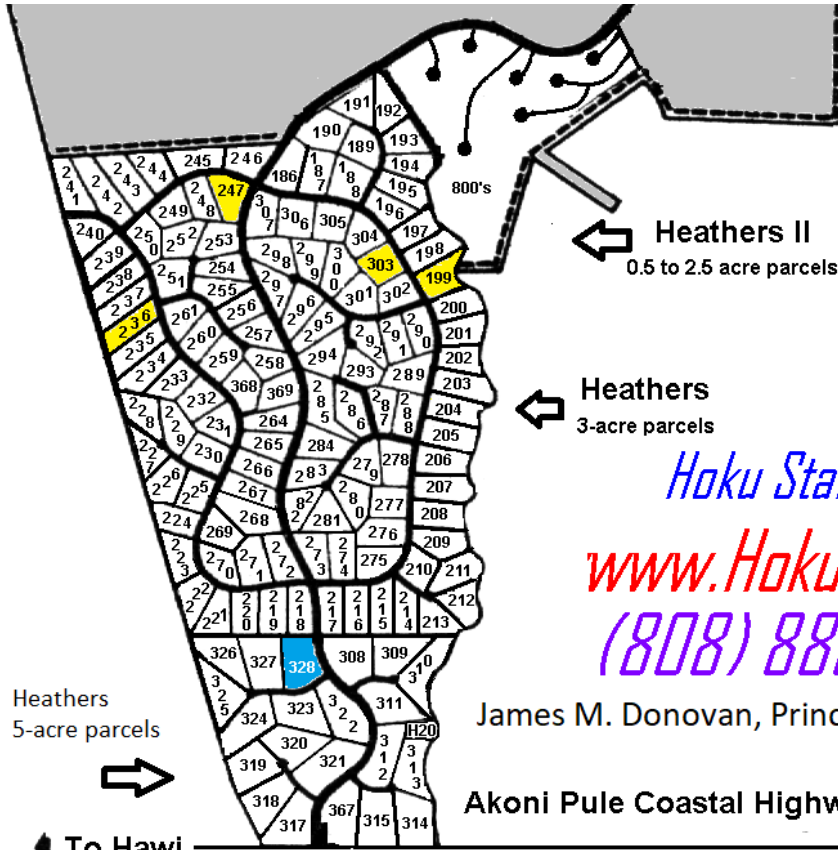

Heathers II
0.5 to 2.5 acre parcels

Heathers
3-acre parcels

Heathers
5-acre parcels

Hoku Star Realty

www.HokuStar.com

(808) 880-9000

James M. Donovan, Principal Broker, RB-19185

Akoni Pule Coastal Highway

◆ To Hawi

To Kawaihae & Kona ◆

Heathers II
1/2 acre to 2.5 acre lots

**For a tour of Kohala Ranch,
call Jim Donovan at
(808) 880-9000**



**You can look up
any and all Big Island**

MLS listings at www.HokuStar.com

Hawaii Hoku Star Realty, LLC
James M. Donovan, Principal Broker
RB-19185

Kohala Ranch - Meadows I

Hoku Star Realty

James M. Donovan, Principal Broker

RB-19185

(808) 880-9000

Copyright, 2024

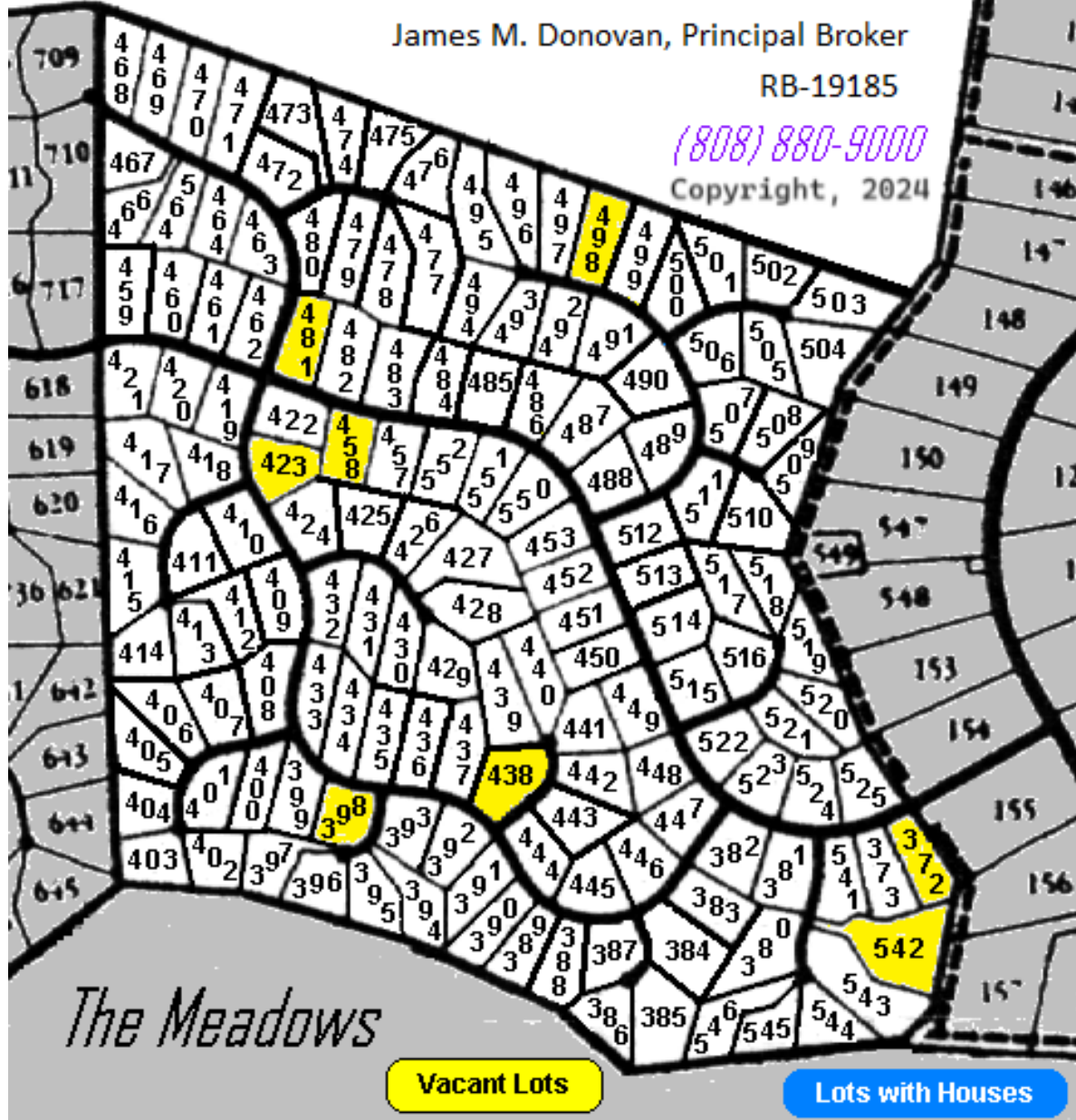

Kohala Ranch - Meadows II

*Hoku
Star
Realty*

www.HokuStar.com

James M. Donovan
RB-19185

(808) 880-9000

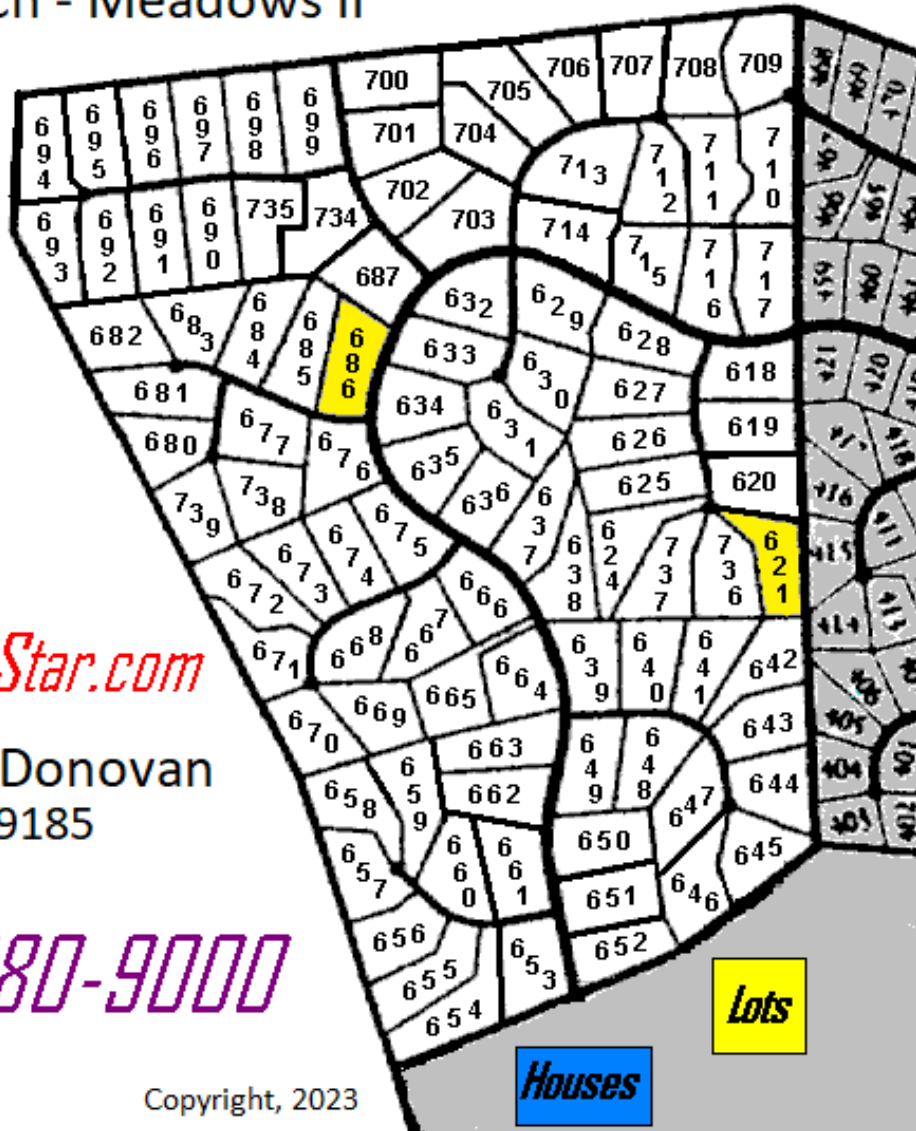

Copyright, 2023

Kohala Mountain Road
To Hawi

Route 250

To Waimea (Kamuela)

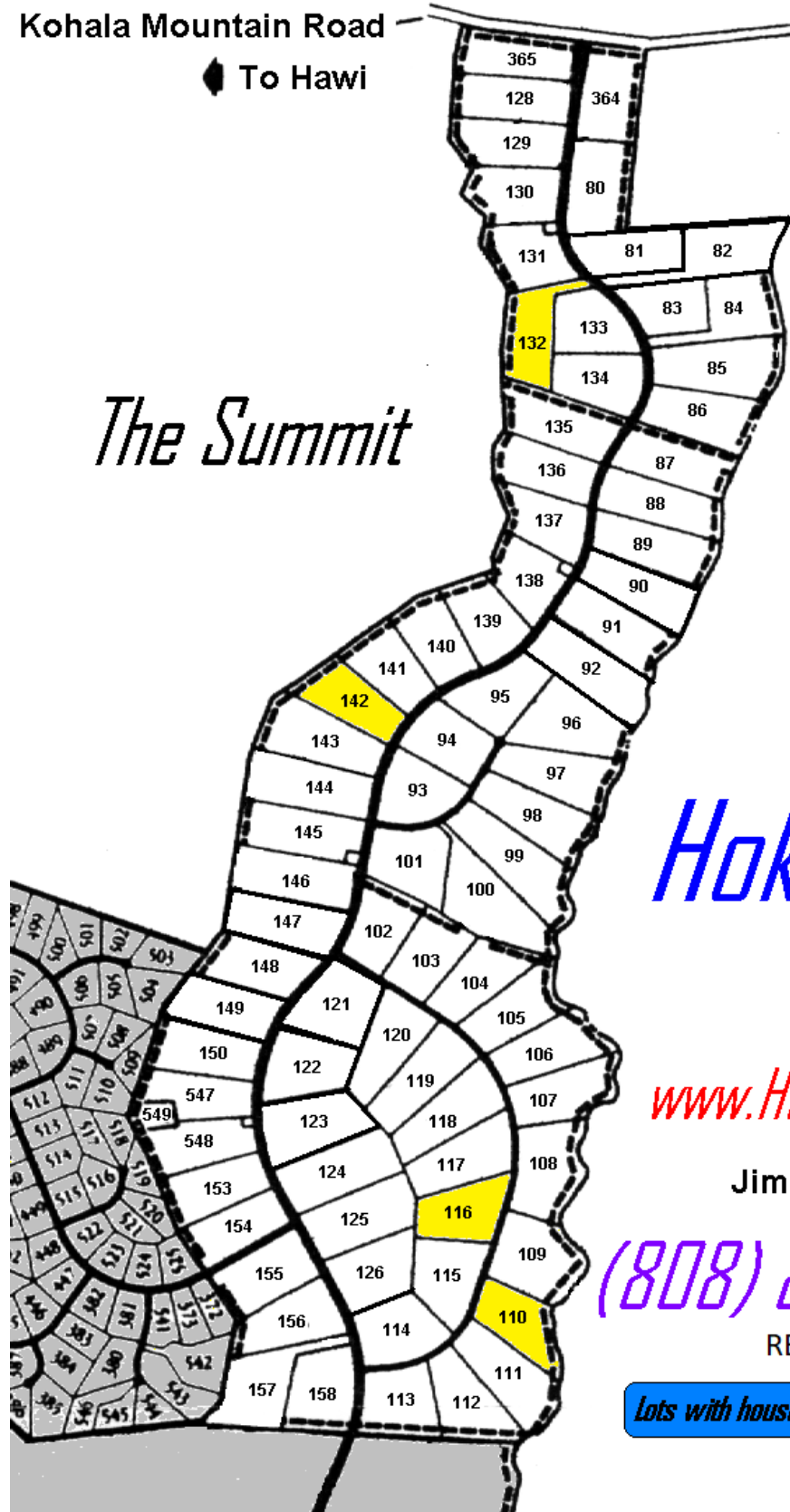

The Summit

Hoku Star
Realty

www.HokuStar.com

Jim Donovan

(808) 880-9000

RB-19185

Lots with houses

Vacant lots